



40 

AND FRESH

April 22-25 - Orlando, Florida

Looking back, Focusing forward

2024 AIAEE CONFERENCE

Association for International Agricultural and Extension Education



Looking back. Focusing forward
2024 AIAEE CONFERENCE

2 *Welcome*
Welcome message from the
AIAEE conference team

4 *At a Glance*
Conference schedule at a
glance

9 *Keynote*
Meet our Conference Keynote
Speaker

10 *Executive Board*
Meet the AIAEE Committee
Leadership team

11 *Committee Leadership*
Meet our Conference Keynote
Speaker

13 *Presentation Schedule*
Learn more about research
being presented

35 *Poster Session*
View information about
our poster session

41 *Tour Information*
Learn more about tour
opportunities

Welcome!

As we gather for this year's event, we embrace a theme that resonates with our collective journey: "40 and Fresh: Looking Back, Focusing Forward." In celebrating four decades of innovation, collaboration, and growth in the field of agricultural and extension education, we also set our sights firmly on the future. The theme encompasses our commitment to honoring the rich history and achievements of our community, while remaining forward-thinking in our approach. Over the past 40 years, AIAEE has played an instrumental role in advancing agricultural education and outreach on a global scale. From pioneering research to transformative practices, our members have continually pushed boundaries and shaped the landscape of agricultural and extension education.

As we reflect on our past successes, we also recognize the challenges and opportunities that lie ahead. Rapid technological advancements, evolving environmental concerns, shifting demographics, and changing global dynamics demand innovative solutions and fresh perspectives. Through this conference, we aim to engage in meaningful dialogue, exchange insights, and forge new pathways that will propel our field into the next era of excellence.

In addition to celebrating 40 years of excellence, we celebrate our growing association. We have record attendance in Orlando this year, making it our largest conference to date. This year's event would not be possible without the support of many. We would like to extend our gratitude to those who have sponsored the conference. We are thankful for our corporate sponsors—the Peace Corps and University of Georgia's Department of Agricultural Leadership, Education, and Communication; event sponsors—University of Florida's Graduate School, University of Florida's Department of Agricultural Education and Communication, University of Florida's Center for Public Issues Education (PIE Center), University of Guelph's School of Environmental Design and Rural Development, and Global Forum for Rural Advisory Services (GFRAS); and full-page program sponsors—Texas A&M University Department of Agricultural Leadership, Education and Communications, Iowa State University's Department of Agricultural Education and Studies, and North Carolina State University's Department of Agricultural and Human Sciences; and half-page program sponsor—The Ohio State University's Department of Agricultural Communication, Education, and Leadership. Your generosity and commitment to advancing agricultural and extension education have made this gathering possible, enabling us to bring together minds from around the world to exchange ideas, foster innovation, and drive positive change.

We would also like to recognize those who have served on the planning committee for the conference. A special thank you to our graduate student planning committee team—Carrie Baker, Juan Montealegre, Sravani Pasula, Arati Joshi, and Dharmendra Kalauni, and faculty planning committee—Sarah Bush, John Diaz, Grady Roberts, Ricky Telg, Carla Jagger, Nicole Stedman, Pablo Lamino, JC Bunch, Sebastian Galindo, and Dale Pracht. We would also like to express our sincerest gratitude to the PIE Center, specifically Ashley McLeod Morin, Karlibeth Leitheiser, and Michaela Kandzer for creating this beautiful program and to Liz Felter and Hannah Wooten from UF/IFAS Extension for their assistance in planning tours.

We extend a warm welcome to all participants, both seasoned and first-time attendees, as we engage in collegial and scholarly discussions this week. Let us chart a course toward a more vibrant, resilient future for agricultural and extension education worldwide.



Sincerely,
Sarah A. Bush, 2024 AIAEE Planning Committee Chair



Looking back. Focusing forward
2024 AIAEE CONFERENCE

SCHEDULE AT A GLANCE

MONDAY, APRIL 22

7:15 – 12:00 pm	Student Service Activity	Meet Bus in Front
9:00 – 11:00 am	Executive Board Meeting	Scarlet A
12:00 – 4:00 pm	Conference Packet Pickup	Pre-Function Space
12:00 – 4:30 pm	Poster Set Up	Coral Ballroom
1:00 – 2:00 pm	Audit Committee Meeting	Scarlet A
2:00 – 3:00 pm	New Member/Student Meeting	Scarlet A
3:00 – 4:00 pm	Professional Development 1	Scarlet A&B
4:30 – 4:45 pm	Welcome	Coral Ballroom
4:45 – 6:15 pm	Poster Session & Reception	Coral Ballroom

HELPFUL INFORMATION

Meeting Room Map

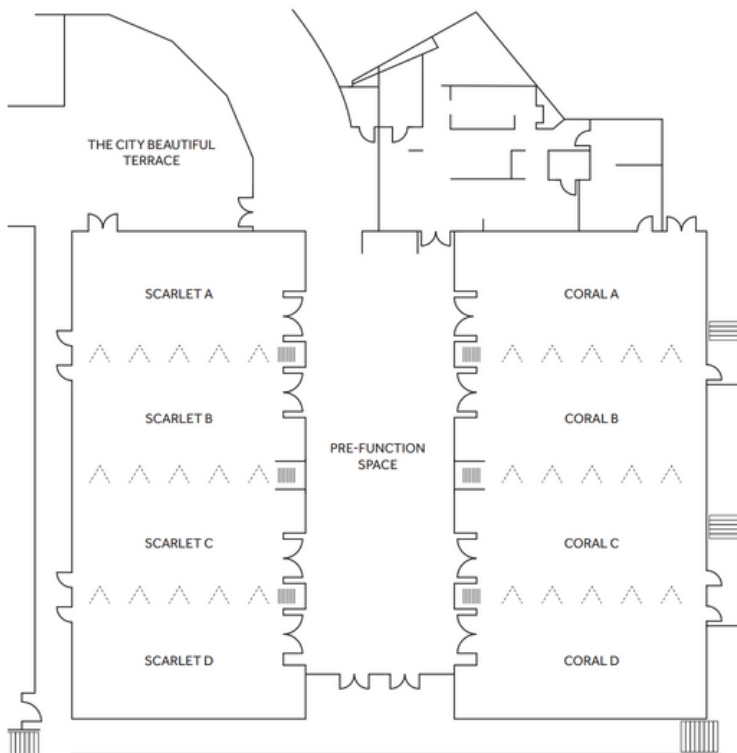

Drury Plaza Hotel

Orlando | Disney Springs Area
 2000 Hotel Plaza Blvd.
 Lake Buena Vista, FL 32830
druryplazahotelorlando.com
 (407)560-6111

TUESDAY, APRIL 23

7:30 – 8:30 am	Conference Packet Pickup	Pre-Function
8:30 – 9:00 am	General Session & Keynote Opening Remarks from AIAEE President Welcome Remarks	Coral Ballroom
9:00 – 10:00 am	Abstract Session 1	Scarlet A - D
	Ideas at Work 1	Coral Ballroom
10:00 – 10:15 am	Break	Coral Ballroom
10:15 – 11:15 am	Professional Development Session 2	Scarlet A - D
11:15 – 12:15 pm	Abstract Session 2	Scarlet A - D
12:15 – 1:45 pm	Lunch Buffet Keynote Address	Coral Ballroom
2:00 – 3:00 pm	Committee Meetings <ul style="list-style-type: none"> • Constitutions and Bylaws Planning • Professional Development • Scholarly Activities • Communications 	Scarlet A Scarlet B Scarlet C Scarlet D
3:00 – 4:15 pm	Abstract Session 3	Scarlet A - D
3:00 – 4:15 pm	Ideas at Work 2	Coral Ballroom
4:30 – 5:30 pm	<i>Journal of International Agricultural and Extension Education</i> professional development workshop	Scarlet A
6:00 pm	Evening on your own	
6:30 pm	Student Social	Meet in lobby to walk to Splitsville, Disney Springs

WEDNESDAY, APRIL 24

8:30 – 9:30 am	Abstract Session 4 Ideas at Work 3	Scarlet A - D Coral Ballroom
9:30 – 10:30 am	Professional Development Session 3	Scarlet A - D
10:30 – 10:45 am	Break	
10:45 – 11:45 am	Abstract Session 5	Scarlet A - D
11:45 – 1:45 pm	Lunch Buffet and Business Meeting	Coral Ballroom
2:00 – 3:00 pm	<i>Journal of International Agricultural and Extension Education Board Meeting</i>	Scarlet A
2:00 – 3:00 pm	Professional Development Session 4	Scarlet B - D
3:00 – 4:00 pm	Abstract Session 6 Ideas at Work 4	Scarlet A - D Coral Ballroom
4:00 – 4:15 pm	Break	
4:15 – 5:15 pm	Abstract Session 7 Ideas at Work 5	Scarlet A - D Coral Ballroom
6:00 pm	Awards Reception	Planet Hollywood

**Planet Hollywood
at Disney Springs**
1506 E Buena Vista Dr
Lake Buena Vista, FL
32830



THURSDAY, APRIL 24

9:00 am	Tour 1	Meet in Lobby
	Tour 2	

Note: Conference participants must have pre-registered for the tours. No last-minute additions or requests to switch tours can be accommodated.

TOUR 1 - URBAN AGRICULTURE

9:00 am	Depart Drury Plaza Hotel	Lobby
10:00 - 10:45 am	Sugar Top Farm	13350 Sugarloaf Ct. Clermont, FL 34715
11:30 - 10:45 am	Long & Scott	26216 County Rd 448A Mt. Dora, FL 32757
12:30 - 1:30 pm	Lunch	
2:15 - 3:00 pm	EverOak Farm	2335 Carrington Dr. Orlando, FL 32807

TOUR 2 - FLORIDA AGRICULTURE AND COMMUNITY FOOD SYSTEMS

9:00 am	Depart Drury Plaza Hotel	Lobby
9:45 am - 12:00 pm	Showcase of Citrus	15051 Frank Jarrell Rd. Clermont, FL 34714
12:20 pm - 3:00 pm	Southern Hills Farms (Includes lunch)	16651 Schofield Rd. Clermont, FL 34714

FRIDAY, APRIL 25

8:00 – 10:00 am	Executive Board Meeting	Scarlet A
-----------------	-------------------------	-----------

To the big-hearted and BOLD:
We need you.



Apply Now

Volunteer opportunities
in 60+ countries



Keynote Speaker

Dr. Abram J. Bicksler

A Global Snapshot of Extension and Advisory Services: Trends and Opportunities



In this session, **Dr. Abram J. Bicksler**, President and CEO of ECHO International, will provide an exciting overview of his take on some of the internal and external global trends shaping our world, food systems, smallholder farming, and agricultural extension and advisory services. This 30,000 foot-view will touch on a multitude of megatrends happening globally that can serve as threats and opportunities to challenge, inspire, synergize, and operationalize our approaches as AIAEE members to work together for a better common future that benefits people and the planet through agriculture.

Dr. Abram J. Bicksler earned his doctorate and master's degrees from the University of Illinois Urbana-Champaign in Natural Resources and Environmental Sciences with a focus on sustainable cropping systems and completed his bachelor's degree at Taylor University in Environmental Science and Biology. As a global leader, networker and researcher in sustainable food systems, Abram has been published in a number of peer-reviewed journals in addition to a diversity of FAO and extension publications. He enjoys combining the practice of agriculture at the farmer-innovator level with the rigors of the scientific method, to enable co-creation and sharing of knowledge.

While at FAO, Dr. Bicksler guided and advised on agroecology and sustainable food systems initiatives in multiple world regions through technical and policy means. Before serving in Rome, Bicksler led the ECHO Asia Impact Center's international staff team, coordinated and implemented regional networking and training events, initiated research culminating in multiple published studies, planned and began execution of the ECHO Asia Small Farm Resource Center, and grew the capacity of the ECHO Asia Seed Bank. As a visionary President/CEO of ECHO, Abram has led the ECHO team in the re-imagining of ECHO as a global organization with four Regional Impact Centers (RICS) serving our diverse and growing network around the world by regionalizing our resources and approaches. Building and serving our diverse network with excellence is at the core of ECHO, and Bicksler has woven this throughout the year-long participatory strategic framework development process to lead and guide ECHO into the next five years of its history while fundraising to operationalize new Regional Impact Centers and initiatives in areas of greatest need and potential around the world.

Executive Board



President

John Diaz, University of Florida, USA
john.diaz@ufl.edu



Secretary

Shannon Norris-Parish, New Mexico State University, USA
norriss@nmsu.edu



Past President

Mary Rodriguez, Ohio State University, USA
rodriguez.746@osu.edu



Student Representative

Garrett Brogan, Texas A&M University, USA
gsbrogan@tamu.edu



President-Elect

Atahaul Chowdhury, University of Guelph, CA
ataharul.chowdhury@uoguelph.ca



Treasurer

Roger Hanagriff, Texas A&M University-Kingsville, USA
roger.hanagriff@tamuk.edu



Member-at-Large Director

Sarahi Morales, Zamorano, Honduras
smorales@zamorano.edu

Committee Leadership

Audit

Kristina Hains
University of Kentucky, USA
k.hains@uky.edu

Communications

Shuyang Qu
Communications Committee Chair
Iowa State University, USA
squ@iastate.edu

Anu Karki
Communications Committee Manager
Iowa State University, USA
akanu@iastate.edu

Conference Planning

Sarah Bush
University of Florida, USA
sab5271@ufl.edu

Constitution and Bylaws

Nathan Conner
University of Nebraska-Lincoln, USA
nconner2@unl.edu

Awards

Fally Masambuka-Kanchewa
Iowa State University, USA
fallymk@iastate.edu

Professional Development

Lacey Roberts-Hill
New Mexico State University, USA
lnrob@nmsu.edu

Scholarly Activities

Anil Kumar Chaudhary - Chair
Penn State University, USA
aak259@psu.edu

Shannon Norris-Parish - Abstract Co-Chair
New Mexico State University, USA
norriss@nmsu.edu

Bryan Hains Abstract - Co-Chair
University of Kentucky, USA
bryan.hains@uky.edu

Bradley Coleman Poster - Co-Chair
Oklahoma State University, USA
b.coleman@okstate.edu

Khondokar Kabir - Poster Co-Chair
University of Guelph, Canada
kabirk@uoguelph.ca

Mary Rodriguez - JIAEE Executive Editor
Ohio State University, USA
rodriguez.746@osu.edu

John Diaz - Managing Editor
University of Florida, USA
john.diaz@ufl.edu

Todd Brashears - Past Editor
Texas Tech University, USA
todd.brashears@ttu.edu

educate

serve

inspire

explore



TEXAS A&M UNIVERSITY
Agricultural Leadership,
Education & Communications

GRADUATE STUDIES

Make an impact on the world!

- Master of Science (M.S.) in Agricultural Leadership, Education & Communications – Thesis & Non-Thesis
- Master of Agriculture (M.Ag.) in Agricultural Development, Distance Education Only
- Master of Recreation and Youth Development
- Doctor of Philosophy (Ph.D.) in Agricultural Leadership, Education & Communications



Learn more here!

educate

serve

inspire

explore

PROFESSIONAL DEVELOPMENT SESSION 1

MONDAY, APRIL 22 | 3:00 – 4:00 P.M.

Professional Development Session 1-A | Scarlet A

Community Asset Management: How to Effectively Engage Partners to Support Extension Programs | *Rachel Pienta*

Professional Development Session 1-B | Scarlet B

Question, Persuade, Refer (QPR) Training: A Tool to Save a Life from Suicide | *Carla Jagger, Daniel Gonzalez, and Laura Valencia*

ABSTRACT SESSION 1 | TUESDAY, APRIL 23 | 9:00 – 10:00 A.M.

Abstract Session 1-A | Theme: [Agricultural Communications](#) | Scarlet A

Evaluating Students' Perceived Self-Efficacy in Intercultural Communication when Traveling Abroad | *Elizabeth Trevizo, Ariel Kent, Parker Greene, Rebekah McCarty, Lacey Roberts-Hill, and Shannon Norris-Parish*

Exploring the Communication Experiences of Pork Industry Professionals to Inform Extension Programming | *Allison Byrd, Alexa Lamm, Catherine Sanders, Fally Masambuka-Kanchewa, Shuyang Qu, Michael Retallick, and Kevan Lamm*

Delphi Analysis to Identify Key Competencies for Extension Communication: Implications for Program Development | *Catherine Sanders, Kevan Lamm, and Elisabeth Ramsey*

Harvesting Insights: Exploring Rural Community Members' Perceptions of Agritourism | *Anthony Caruso and Audrey King*

Abstract Session 1-B | Theme: [Agricultural Education](#) | Scarlet B

Goal Oriented Learning: Using Learning Style Preferences to Inform Educational Practice in Nepal | *Emily Dustman, Alexa Lamm, Millicent Oyugi, Kevan Lamm, and Sudarshan Adhikari*

Visualizing Culture: Using Photovoice as Preflection and Reflection in Study Abroad | *Sherrie Ray, Meikah Dado, and Jack Elliot*

Lasting Impact: Participants' Reflections on a Study Abroad Experience Five Years Later | *Gaea Hock and Courtney Meyers*

Exploring the Impact of Learning Styles on Critical Thinking Skills in Nepal | *Emily Dustman, Alexa Lamm, Millicent Oyugi, Kevan Lamm, and Sudarshan Adhikari*

Abstract Session 1-C | Theme: [Extension Education](#) | Scarlet C

Resilience and Identity: A Study of a Rural Community in Honduras Ignoring the Propaganda of the American Dream | *Alma Perez, Amy Boren Alpizar, and Noily Alpizar*

Exploring the Multifaceted Impact of Knowledge on Behavior Change: Insights from the Master Gardener Volunteer Program in Florida | *Arati Joshi, John Diaz, Anil Chaudhary, Jay Jayratne, and Sebastian Galindo*

Is Agricultural Extension and Education about Technology Transfer or Human Development? | *Aneesha Kakara & Fally Masambuka-Kanchewa*

Looking Back, Focusing Forward: Extension's Support During Lockdown and Key Lessons Learned | *Arati Joshi, Sebastian Galindo, John Diaz, David Outerbridge, and Trent Blare*

Abstract Session 1-D | Theme: [Extension Education](#) | Scarlet D

Examination of Sources for Lack of Interest to Pursue Agricultural Related Careers Among African Youths | *Daniel Nyarko, Fally Masambuka-Kanchewa, and Shuyang Qu*

Assessing Barriers to Post-Harvest Innovation Adoption in Ghana | *Misty Lambert, Namah Taku-Forchu, Jonathan Ulmer, & George Opit*

Revitalizing Agricultural Extension Undergraduate Curriculum in Sub-Saharan Africa | *Murari Suvedi, PVK Sasidhar, Charity Chanza, Maheshwari Elapata, Lindie Von Maltitz, and Kristin Davis*

IDEAS AT WORK 1 | TUESDAY, APRIL 23 | 9:00 – 10:00 A.M.

Abstract Session 1 | Theme: [Extension Education](#) | Coral Ballroom

Farmers' Knowledge of Using Forecast Information in Crop Production: A Case of Rural Bangladesh | *Mst Sharmin Akter, Mohammed Nasir Uddin, Swarnasree Sarker, M Maruf Hasan, Saifur Rahman, Joseph L. Donaldson, Ataharul Haq Chowdhury*

Evaluation of the Ricochet 4-H Experiential Learning Leadership Program | *LeAnne Pollock, Xin Li, Darlene Locke, Jun Wang*

Looking Back on Challenges to Leverage Future Opportunities: A Collaborative Autoethnographic Reflection of International Research and Engagement Projects | *Olivier Ntaganzwa, Neil Knobloch, Rebecca Witinok-Huber*

A Landscape Analysis of Extension and Advisory Services and Barriers Faced by Farmers in Adopting Agricultural Technologies in Senegal | *Steven Franzel, Soniia David, Mercy Akeredolu, Amadou Ndiaye, Seydou Niaré*

Effectiveness of Climate-Smart Agriculture Technologies for Drought Mitigation in Bangladesh: A Farmer Perspective | Mohammed Uddin, Md. Mehedi Hasan, M. Asaduzzaman Sarker, Mst. Sharmin Akter, Mohammad Hasan, Saifur Rahman, Khondokar Kabir, M. Salim Uddin, Asif Ishtiaque, Ataharul Chowdhury

Best Practices for Working with People with Disabilities in the Agricultural Sectors | Vanessa Spero, Serap Gorucu, Tony Delisle, David Diehl

PROFESSIONAL DEVELOPMENT SESSION 2

TUESDAY, APRIL 23 | 10:15 – 11:15 A.M.

Professional Development Session 2-A | Scarlet A

Breaking Barriers: Insights on Mentoring of International Graduate Students | Juan M. Montealegre, Kate H. Fletcher, and T. Grady Roberts

Professional Development Session 2-B | Scarlet B

Participatory Methods for Social and Behavioral Change in Agricultural Extension Programs | Carmen Benson and Jen Peterson

Professional Development Session 2-C | Scarlet C

A Practical Guide for Integrating Higher Education, Extension, and International Initiatives | Amanda Dickson and Taryn Devereux

Professional Development Session 2-D | Scarlet D

Participatory Action Research: An Opportunity to Connect with Rural Communities | Angela M. Ospina



THE PIE CENTER

The UF/IFAS Center for Public Issues Education in Agriculture & Natural Resources (PIE Center) examines how people think about, form and act on opinions regarding complex agricultural and natural resources issues.

TURNING RESEARCH INTO PRACTICE



SOCIAL SCIENCE RESEARCH

Using a social science perspective, the PIE Center conducts research on issues related to agriculture and natural resources.



COMMUNICATION & OUTREACH

Communication deliverables are developed to integrate findings from research to effectively reach target audiences.



EDUCATIONAL PROGRAMS

Educational programs help to increase public awareness of and engagement in agricultural and natural resources issues.

PROJECT AREAS

- Public opinion surveys
- Focus groups
- Organizational planning
- Communication toolkits
- Science by the Slice podcast
- Video production
- PIE Fellows program
- PIE Academy courses

**SCAN THE QR CODE
TO LEARN MORE**



UF/IFAS PIE Center



@uf_piecenter



@PIECenter

ABSTRACT SESSION 2 | TUESDAY, APRIL 23 | 11:15 – 12:15 P.M.

Abstract Session 2-A | Theme: [Agricultural Communications](#) | Scarlet A

Awareness of Women Cassava Processors in the Utilization of Social Media to Advance Agricultural Marketing in Ikole Local Government Area, Ekiti, Nigeria | *Olufunke Olatunji, Sunday Ogunjinmi, Ajayi Damilola*

The Influence of Water Science Knowledge on Water Policy Aetudes and Preferences: Re-examining the Knowledge Deficit Model | *Madison Dymment, Matthew Gold, Sadie Hundemer*

Enhancing Global Awareness: Utilizing the Green Revolution Simulation Game to Enrich Students' Understanding of Smallholder Farmers' Decision-Making Processes | *Stephen Mukembo, Kelly Wilson, Corinne Valdivia, Laura McCann*

Abstract Session 2-B | Theme: [Agricultural Education](#) | Scarlet B

The International Doctoral Student Experience: The Outcomes of a One-Year Mentored-Teaching Program | *Kate Fletcher, Juan Montealegre, T. Roberts*

An Empirical Comparison of Individual-Level and Country-Level Cultural Dimensions in College of Agriculture Students | *Allison Byrd, Alexa Lamm, Kevan Lamm, Jessica Holt, Rochelle Sapp*

Building Globally Competent Teacher Educators: A Jamaican and American Duoethnography | *Audie Cherry, Rose Marie Somers*

Mapping Sustainability: A Phenomenology of Filipino Farmer Perceptions Toward Sustainable Agriculture Practices | *Audie Cherry, Kevin Layfield, Joseph Donaldson, Christopher Eck*

Abstract Session 2-C | Theme: [Leadership](#) | Scarlet C

Bridging Borders: Insights from a US-Ghanaian Classroom Collaboration | *Jessica Spence, Frank Adusei, Van Crowder, Joseph Obeng-Baah, Daniel Odoom*

Effect of Cultural Norms and Traditional Beliefs on the Lived Experiences of Women in Agriculture in Rural Communities | *Abasiama-Arit Aniche, Katherine McKee, Jackie Bruce*

Implications for Supporting Historically Marginalized Populations to Achieve Success in Higher Education: Views of Native American Undergraduate Students in a College of Agriculture -- A Phenomenological Study | *Kyleigh Hilburn, Lauren Cline, M. Craig Edwards, Courtney Brown, Justin Moss*

Post-conflict: Redefining the Definition and Reimagining a Working Framework for Agricultural Development | *Lindsay Naumann-Montoya, Mary Rodriguez*

Abstract Session 2-D | Theme: [Extension Education](#) | Scarlet D

The 2021 Winter Storm Uri in the Texas' Dairy Industry: A Farmers' Preparedness and Response Study | Emmanuel Okolo, Rafael Landaverde, David Doerfert, Chandra Elbert, Darren Hudson, Juan Pineiro

Evaluating Public Perceptions and Behaviors Regarding UGA Extension Horse Resources using Diffusion of Innovations Theory: A Preliminary Study | Robyn Stewart, Barry Croom, Brooklyne Wassel, Ashley Best

Enhancing Residential Water Conservation: Insights from a Rainfall-Based Signage Intervention in Florida, United States | John Diaz, Laura Warner, Colby Silvert

A Comparative Systematic Literature Review of Youth Participatory Action Research: Unveiling Design and Applications in the Americas | John Diaz, Cody Gusto, Camilo Noreno Herrera, Laura Valencia, Ivan Munoz Echeverri, Paola Velasquez Quintero, Jose Monslave Lopez

ABSTRACT SESSION 3 | TUESDAY, APRIL 23 | 3:00 – 4:15 P.M.

Abstract Session 3-A | Theme: [Extension Communications](#) | Scarlet A

Experience Journeys: Evaluating Experience Value-During-Use of 4-H Programs | Darlene Locke, Gary Ellis, Jingxian Jiang

Storytelling at Educational Travel: Effects of Self-Relevance, Verisimilitude, Props, and Music | Emily Catalan, Gary Ellis, Andrea Ettekal, Elsa Murano, Darlene Locke

Interactive Communication: A Plausible Way to Bridge Gaps Between Science and Society through Transdisciplinary Research Environments | Parmveer Singh, Anil Kumar Chaudhary

From Potential to Practice: Gender Transformative Approaches in Smallholder Agricultural Commercialization | Colby Silvert, John Diaz, Steven Cole, Renata Serra, Laura Warner, Grady Roberts

Planning for Parity: Learning from Past Projects and Increasing Women's Access to Agricultural Programming in the Future | Mary Halbleib, Berit Dinsdale

Abstract Session 3-B | Theme: [Extension in Action](#) | Scarlet B

We Need to Make Sure Not to Leave Behind the Working Adults | Colleen Gariton, T. Grady Roberts

Examining Moderator Effects for the Behavioral Intent of Online Distance Education by Florida Extension Agents: Global Implications | Wayne Hobbs, Laura Warner, Jamie Loizzo, Matt Benge, Sandra Wilson

Preventative Innovation Adoption: Operationalizing Diffusion of Innovation to Understand On-Farm Food Safety Uptake | Dharmendra Kalauni, Laura A. Warner, Matt Benge, Michelle D. Danyluk

Educational Impacts of Tours in an Extension Garden | *Jamielyn Daugherty*

Exploring the Best Practices Used by Excellent Extension Mentors | *Karlibeth Leitheiser, Matt Bengé*

Abstract Session 3-C | Theme: [Extension with a Global Perspective](#) | Scarlet C

Redirecting Extension Learning Systems towards Gaining and Sharing New Knowledge for Increasing Rice Production in Nigeria: Evidence of LINKS - DFID Project | *Ali Abdullahi, M. Suleiman, A. Adnan, A. Danbaba, A. Idris, Tafida Ibrahim*

Enhancing Gender Participation in Sustainable Agricultural Practices through Self-Efficacy: A Proposition for Promoting Equitable Adoption Among Smallholder Farmers | *Ange Asanzi, Sravani Pasula, Damilola Ajayi, Mireille Mvondo-She, Arati Joshi, Colby Silvert*

Agricultural Innovations, Extension, and Development in Nigeria: An Expert Opinions Study for Future Priority Areas | *Anjorin Adeyemi, Rafael Landaverde, Kim Dooley, Zhihong Xu*

Differences in Perspectives Regarding Adopting Digital Technologies by Different Actors Within Rainbow Trout Farming in Ontario, Canada | *Ataharul Chowdhury, Khondokar Kabir*

Innovation Brokering and Trust Building in a Privatized Extension Regime: Probing into the "Precision Livestock Farming" Innovation System at Reading Area of Berkshire, England | *Samrat Sikdar, David Rose*

Abstract Session 3-D | Theme: [Extension through a Domestic Lens](#) | Scarlet D

Assessing Agricultural Education Needs: A Study of Houston Independent School District Middle School Teachers | *Sarbjeet Kaur, Barbara Bolick, Darlene Locke, Jun Wang*

Experiences, Interests, and Need for Information on Climate Adaptation Practices among Stakeholders in California | *Samuel Ikendi, Vikram Koundinya, Namah Taku-Forchu, Natalia Pinzon, Lauren Parker, Leslie Roche, Mark Cooper, Daniele Zaccaria, Steven Ostoja, Tapan Pathak*

An Analysis of Factors Influencing Agribusiness Success and Failure in Accra and Kumasi Metropolises, Ghana | *Jeffrey B. Appiagyei, Harvey S. James, Stephen C. Mukembo, Kerry Clark, Douglas D. Morsel*

Enlightening Agricultural and Rural Development Specialists about the Potential of Animal-Powered Technology for the Global South: Insights from the Amish and Mennonite Communities | *Whitney Figland Cook, Yakubu Wule, Richie Roberts, James Hynes, Gary Briers, M. Edwards*

Extension Agents' Competencies in Promoting Agroforestry Practices in the Global South | *Brian Flanagan, Amy Boren-Alpizar, Gary Wingenbach, Robert Strong, David Lawver*



Capacity Development & Extension

COMMUNITY DEVELOPMENT
 SYSTEM THEORY & COMPLEXITY SCIENCE
 COMMUNICATION
 ADULT EDUCATION
 ORGANIZATIONAL CHANGE
 RESEARCH
 PROGRAM & PROJECT MANAGEMENT
 EXTENSION & KNOWLEDGE MANAGEMENT
 ICT & DIGITAL TECHNOLOGIES

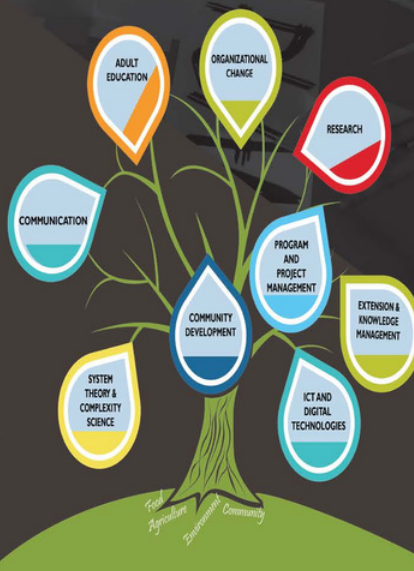

To learn more about improving life through our Graduate Programs in Capacity Development and Extension, Rural Planning and Development, Landscape Architecture, and Rural Studies (PhD) within the School of Environmental Design and Rural Development please visit: www.uoguelph.ca/sedrd/

IMPROVE LIFE.

IDEAS AT WORK 2 | TUESDAY, APRIL 23 | 3:00 – 4:15 P.M.

Ideas at Work 2 | Theme: [Extension Education](#) | Coral Ballroom

Factors Driving the Adoption of Drought Tolerance Varieties of Rice in Northern Bangladesh | *Md Rezaul Karim, Ataharul Chowdhury, Farha Taznin*

Toolkit for Investing in Human Capital in Agriculture: Project Lessons from a Global Study | *Kristin Davis, Johanna Gammelgaard, John Preissing, Steven Franzel*

Growing Healthy Habits: Empowering Communities through Gardening Education to Combat Food Deserts | *Emily Marois, Kara Krueger, John Roberts, Yesenia Rodriguez, Anna Meszaros, Ronald Rice, Frank Dowdle*

Inspiring Community Change with Native Planting Projects in Parks | *Tiare Silvasy*

The Food as Medicine Initiative: When Agriculture Meets Public Health | *Rebecca Elliott, Jeremy Rhoden*

Plant to Plate: Linking the Food System to Sustainability and Health | *Mark Bailey, Amanda Marek, Rebecca Elliott, Jeremy Rhoden, Catherine Campbell, Lynn Nobles*

Building the Bridge of School Nutrition, 4-H Youth Development, and Family & Consumer Sciences | *Daniel Collins, Erin Kvach*

Onboarding of Agricultural Extension Agents: Florida's ANR 101 Program | *Marcelo Wallau, Matt Benge, Ashley Kuhn*

ABSTRACT SESSION 4 | WEDNESDAY, APRIL 24 | 8:30 – 9:30 A.M.

Abstract Session 4-A | Theme: [Agricultural Communications](#) | Scarlet A

A Big Data Analysis of Twitter Conversations about Food Deserts and Food Swamps | *Hannah Ford, Courtney Meyers, Scott Burris, Modhurima Dey Amin, Syed Badruddoza*

Hit the Like Button: Evaluation Research of [University's] Social Media Engagement | *Raquel Taylor, Kasey Harmon, Nathan Conner, Taylor Ruth, Mary Emery*

Tools and Resources Used to Access Information about Adaptation Strategies to Climate Change: The Case of Farmers in Pakistan | *Sana Ullah, Maria Navarro*

Product Labeling and Consumer Perceptions of Foods Containing Bioengineered Ingredients: Exploratory Research Combining Eye-Tracking and Survey Data | *Blake Colclasure, Josh Spomer, Taylor Ruth, Jamie Greig*

Abstract Session 4-B | Theme: [Agricultural Education](#) | Scarlet B

Seeds of the Past, Harvest of the Future: Youth Involvement in Sub-Saharan African Agriculture | *Jaehyun Ahn, Andrea Efekal, Isaac Appiah, Matt Baker*

The Status of Reading in Middle Grades Agricultural Education Classrooms: A Preliminary Study | *Jessica Fife, Dan Croom*

Fostering Student Career Success: Insights from Agricultural Educators on the Significance of Entrepreneurial Competencies | *John Tummons, Stephen Mukemo, Jon Simonsen, Nathan Smith*

Abstract Session 4-C | Theme: [Migration and Reform](#) | Scarlet C

Exploring Migration Dynamics and Drivers: A Convergent Mixed-Method Study of Casa del Migrante San José, Honduras | *Mabely Romero Lopez, Bernardo Trejos, Juan Flores, Pablo Lamino Jaramillo*

Pursuing the American Dream or Living a Nightmare? Examining the Migration Cycle in Rural Honduras | *Alma Perez, Amy Boren Alpizar, Xiomara Torres*

The Promised Land: The Perspectives of Rural Inhabitants Facing Land Conflict and Agrarian Reform in Colombia | *Angela Ospina, Amy Boren Alpizar*

Perspectives of Farmers in a Process of Substitution of Illicit Crops in Northwestern Colombia | *Angela Ospina, Amy Boren Alpizar*

Abstract Session 4-D | Theme: [Extension Education](#) | Scarlet D

Consumers' Perceptions and Attitudes Toward Genetically Modified Organism (GMO) Products | *Gabriela Suchiapa Magdaleno, Lauren Underwood, M. Todd Brashears, Mindy Brashears*

Perceptions and Motivations about Migration in Southern Mexico Seen through the Lens of Civil Association Leaders in Chiapas | *Gabriela Suchiapa Magdaleno, Lauren Underwood, M. Todd Brashears, Mindy Brashears*

Perceptions and Adoption Level of Digital Agricultural Technologies (DAT) by Farmers in Haryana State of India | *Hema Lingireddy, Hansram Meena, Rama Radhakrishna*

Youth Development and Ego Resilience Among Haitian Farmworker Youths: Implication for Global Practice | *Beatrice Pierre, Tracy Irani, Jennifer Doty, Kate Fogarty, Sebastian Galindo, Latoya O'Neal*



Advance Opportunities at UF Agricultural Education and Communication

On-Campus Graduate Programs

The AEC graduate program at the UF offers degrees of Master of Science and Doctor of Philosophy. While obtaining a degree in Agricultural Education and Communication, students may **specialize** in **Agricultural Education, Agricultural and Natural Resource Communication, Agricultural Leadership Education, or Extension Education**. AEC also offers graduate assistantships to qualified candidates. For more information on the graduate program and admissions visit the AEC website at <https://aec.ifas.ufl.edu/graduate/> or contact J.C. Bunch, Graduate Program Coordinator at bunchj@ufl.edu, or Peggy Lowenstein, Academic Program Specialist at delliingp@ufl.edu.

Master of Science Online

The AEC M.S. degree is a six-semester program tailored to meet the needs of busy professionals who are looking for a distance degree program that is compatible with their current work. All classes are online, and available for you to complete when your schedule allows throughout the semester. Similar to in-person students may **specialize** in **Agricultural Education, Agricultural and Natural Resource Communication, Agricultural Leadership Education, or Extension Education**. PLUS: all courses are asynchronous, and there are no residency requirements, making the price the same no matter your location! Learn more from the AEC website at <https://aec.ifas.ufl.edu/elearning/>.

Graduate Certificates

AEC offers 3 graduate certificates:

- Agriscience Teacher Preparation
- Teaching & Learning in Agriculture and Life Sciences
- Agriculture and Natural Resources

Learn more about graduate certificates at the AEC website:

<https://aec.ifas.ufl.edu/graduate/graduate-certificates/>

IDEAS AT WORK 3 | WEDNESDAY, APRIL 24 | 8:30 – 9:30 A.M.

Ideas at Work 3 | Theme: [Extension Education](#) | Coral Ballroom

Creating a Process to use the Unused, Rich Data of Open-Ended Questions | *Colleen Gariton, Glenn Israel, T. Grady Roberts*

When Opposites Attract: A Case Study of International Volunteers and Small-Scale Farmers in Latin America | *Michael Moscarelli, Theresa Murphrey, Gary Wingenbach, Robert Strong*

A Lesson on Living and Learning: A Case Study Approach to Understand How the Lived Experiences of An Extension Specialist Can Influence Students' Perceptions of Extension | *Cheng-Xian Yang, Sydney Honeycutt, Lauri Baker, Trent Blare*

Describing Covid-19's Impacts on New Americans' Food Access and Mental Health | *Benard Walumbe, Alexis Zickafoose, Mary Rodriguez*

Incorporating Environmental Justice to Address Fracking-related Potential Health Inequalities in [State] Extension | *Sharmistha Basak, Anil Kumar Chaudhary*

Testing the Validity of Self-Reported Measures | *Sharmistha Basak, Anil Kumar Chaudhary, John Diaz, Jay Jayaratne*

PROFESSIONAL DEVELOPMENT SESSION 3

WEDNESDAY, APRIL 24 | 9:30 – 10:30 A.M.

Professional Development Session 3-A | Scarlet A

Setting the Stage: A Practical Approach to Becoming an Effective Peer Reviewer | *Kameron Rinehart, Courtney Meyers, and Todd Brashears*

How to Become a Successful Member of Transdisciplinary Research (TDR) Teams | *Parmveer Singh and Anil Kumar Chaudhary*

Professional Development Session 3-B | Scarlet B

Modernizing the Extension Internship Experience | *Charlotte Emerson, Cathy Carr, and Brian Myers*

Instructional Coaching: A Method for High-Impact Mentoring | *Heather Nesbitt, Elanie Mason, Carla Jagger, and JC Bunch*

Professional Development Session 3-C | Scarlet C

Realizing the Power of Your Brand: How Partnership Marketing Maximizes Engagement and Reaches New Audiences | *Timothy McDermott*

USAID Farmer-to-Farmer Program | *Robert Maher*

How to Use Digital Learning Platforms and Agricultural Workforce Development: A Case of AgroHive | *Chiamaka Ndukwu, Sarah Bush, and Natalie Coers*

Peer-learning to Enhance Research and Engagement Impacts in Developing Countries: Reflecting on Challenges and Opportunities using the Feminist Systems Thinking Principles | *Rebecca Witinok-Huber, Neil A. Knobloch, and Olivier Ntaganzwa*

Ready-to-Use Curriculum to Prepare Future Agricultural Educators to Lead Women's Empowerment Programming Globally | *Theresa Murphrey, Carmen Benson, Danette Philpot, and Sophia Wegeng*

Professional Development Session 3-D | Scarlet D

Coming Back To The World of Extension, Perspectives On Surviving As An Experienced "New" Agent | *Robbie Jones*

Investing in Farmers: A Toolkit to Strengthen Famer Capacities | *Steven Franzel*

Using Ripple Effects Mapping for Assessing the Impact of Extension Programs | *Vikram Koundinya and Samrat Sikdar*

Getting on PAR (Participatory Action Research) with Participatory Methods like PRA (Participatory Rural Appraisal) and RRA (Rapid Rural Appraisal) | *Garrett Brogan*

Chat G"TA": Using AI in Agricultural and Extension Education | *Bradley Coleman, Audrey E. H. King and Hannah E. Shear*

ABSTRACT SESSION 5 | WEDNESDAY, APRIL 24 | 10:45 – 11:45 A.M.

Abstract Session 5-A | Theme: [Agricultural Communications, Education, and Leadership](#) | Scarlet A

There's a Mouse in our Greenhouse: Exploring the Global Impact of Agricultural Edutainment | *Bailey Watson, Caroline Brooks, Taylor Ruth, Jamie Greig*

Impact of an International Internship at a U.S. Land-grant University on Rural Colombian College Students | *Carlos Parra, Neil Knobloch*

Internationally Based Supervised Agricultural Experience Programs: An Exploration of Teaching Methods and Supervision | *Taylor Bird, Eric Rubenstein, Amber Rice*

Adult Learner Perceptions of an International Seminar in an Agricultural Leadership Program | *Emily Manuel, Lauren Cline, Brooklyn Evans*

Abstract Session 5-B | Theme: [Agricultural Education](#) | Scarlet B

Bridging the Gap: Evaluating Male and Female Agricultural Teachers' Entrepreneurial Competencies | *Stephen Mukembo, John Tummons, Jon Simonsen, Nathan Smith*

Tracing Global Experiences to Employer Favorability at an International Agriculture NGO | *Sarah McCord, Christi Sudbrock, Benjamin Onyango, Kara Wolfe*

Enablers and Barriers to the Adoption of Gender-Responsive International Agricultural Research, Teaching, and Outreach | *Carmen Benson, Lisa DeLeon, Theresa Murphrey*

Abstract Session 5-C | Theme: [Agribusiness](#) | Scarlet C

Coffee Agroecological Systems, Adaptation, And Sustainability in Valle Del Cauca, Colombia | *Juan Montealegre, Catherine Tucker, T. Grady Roberts*

Do Stakeholders Share their View of the Competencies Needed in the Agrifood Systems of Latin America? | *Sarahi Morales, Ana Maier*

Guest Motivations for Visiting Agritourism Operations | *Alexis Zickafoose, Mary Rodriguez*

Abstract Session 5-D | Theme: [Extension Education](#) | Scarlet D

Perception of the [Watershed] Residents about the Sustainability of Agriculture in the Urbanized Landscapes | *Parmveer Singh, Anil Kumar Chaudhary*

Using Community-Based Research to Understand Status of Drinking Water Quality and Potential Health Effects among Plain-Sect Community | *Parmveer Singh, Anil Kumar Chaudhary, Sharmistha Basak*

Examining Extension Specialists' Roles, Responsibilities, and Challenges to Fulfilling their Extension Responsibilities | *Matt Bengel, Karlibeth Leitheiser*

Perceptions and Experiences of Precision Agricultural Technology Adopters: A Multi-Case Study of Taiwan and the USA | *Gilbert Odilla, Pin-Hsueh Lee, David Lawver, Amy Boren-Alpizar*

IOWA STATE UNIVERSITY

Department of Agricultural Education and Studies
Graduate Programs



AN ADVANCED
DEGREE HERE
WILL GET
YOU PLACED,
ANYWHERE.

GRADUATE DEGREES OFFERED

Doctor of Philosophy (Ph.D.) in Agricultural Education

Master of Science (M.S.) in Agricultural Education

- Thesis Option
- Non-Thesis Option (available on campus or online)
- Teacher Certification Option

Certificate in Education and Outreach in Agricultural and Natural Resources (ANR) (available online)

Students enrolled in our online programs are eligible for resident (in-state) tuition.

Online programs are designed for working educators and professionals.

ABOUT THE DEPARTMENT

- High quality programs with coursework taught by renown faculty.
- Expertise in a wide set of agricultural education interests and perspectives.
- Participants in state, national, and international research and development efforts.
- Award-winning faculty for exemplary work in teaching and research.
- Research focused in experiential learning, educational evaluation, and communication technologies.

COURSEWORK TOPICS

- Needs Assessment Analysis
- Research Design and Analysis
- Policy and Trends in Agricultural Education
- Planning and Development
- Delivery and Learning Systems
- Philosophy and Knowledge Base of Agricultural Education
- Administration, Supervision, and Leadership Development

CONTACT US

NANCY GRUDENS-SCHUCK, PH.D.

Director of Graduate Education
ngs@iastate.edu

MICHAEL MARTIN, PH.D.

Associate Director of Graduate Education
mjm4@iastate.edu

FOR MORE INFORMATION



PROFESSIONAL DEVELOPMENT SESSION 4

WEDNESDAY, APRIL 24 | 2:00 – 3:30 P.M.

Professional Development Session 4-A | Scarlet B

Extension Program Capacity Building: Three Counties Share Success Stories | *Rachel Pienta, Claire Davis, and Evie Hunter*

Big Data for Sustainable Development: Building Extension's Capacity for Addressing Complex Agricultural Challenges | *Sarah A. Bush and Carrie N. Baker*

Professional Development Session 4-B | Scarlet C

Cross-cultural Differences in Agricultural Education and Extension | *Renzo Ceme Vinces and Pablo Lamiño Jaramillo*

Culturally Responsive Evaluation for Promoting Equity and Communicating Impact | *Catherine (Katie) Sanders and Rafael Landaverde*

Professional Development Session 4-C | Scarlet D

Take a Trip Without Leaving Your Seat: Using Interactive Virtual Tours to Introduce Students to Agriculture Facilities | *Gaea Hock and Courtney Meyers*

Navigating the Fulbright Journey: Insights and Advice from a Fulbright Australia Scholar | *Courtney Meyers*

ABSTRACT SESSION 6 | WEDNESDAY, APRIL 24 | 3:00 – 4:00 P.M.

Abstract Session 6-A | Theme: Perceptions of Extension Efforts | Scarlet A

Assessing the Determinants of the Farmers' Adaptive Capacity to Climate Change in Rajshahi District of Bangladesh | *Mohammad Anamul Haque, Md. Azam, Mohammad Faruque, Mohammad Rahman*

Farmers' Attitude Towards Integrated Crop Management for Sustainable Vegetable Production in High Barind Tract of Bangladesh | *Mohammad Anamul Haque, Md. Mannan, Md. Azam, Mohammad Faruque*

Land Grant University Respondents' Beliefs about International Agricultural Issues | *Adam Wray, C. Baker, Seth Jordan, Gary Wingenbach, Rafael Landaverde*

School Gardens as a Tool to Promote Agroecological Practices Among Children | *Xiomara Torres Eva, Sarahi Morales*

Abstract Session 6-B | Theme: [Agricultural Interactions](#) | Scarlet B

Mapping A Pluralistic Mentoring Environment for International Graduate Students Studying Agriculture | *Juan Monteague, Grady Roberts*

The Use of Moodle Platform for e-Learning at Botswana University of Agriculture and Natural Resources | *Keba Hulela, Fally Masambuka-Kanchewa, Dorcus OOkeditse*

Exploring the Interplay of Nationality, Gender, and Age on Undergraduate Students' Learning Styles: An In-depth Analysis Using Kolb's Learning Style Inventory | *Millicent Oyugi, Emily Dustman, Alexa Lamm, Kevan Lamm, Sudarshan Adhikari*

Abstract Session 6-C | Theme: [Extension Education](#) | Scarlet C

Participatory Evaluation: How Ecuadorian Agricultural Associations Perceive the Implementation of the Farmer-to-Farmer Program | *Renzo Ceme Vinces, Pablo Lamiño Jaramillo, Amy Boren Alpizar*

Knowledge and Usage of Climate Smart Practices among Rice Farmers in Nigeria | *Bolaji Fawole, Sidiqat Aderinoye-Abdulwahab*

Reading Ecosystem Services through Urban Agriculture: The Case of Urban Gardens of Thiruvananthapuram Corporation, Kerala, India | *Sreedaya Sarojini, Riza Mathew, Archana Shaji, Sravani Pasula*

Characteristics of Social Media Use by Government Agricultural Extension Workers in Nepal | *Sudarshan Adhikari, Emily Buck, Narayan Raj Joshi, Ram Hari Timilsina, Pankaj Raj Dhital*

Abstract Session 6-D | Theme: [Extension Education](#) | Scarlet D

Programming with Purpose: A Q-Sort Approach to Understanding Program Priorities for A State Extension System in the U.S. | *Megan Cantrell, Lauri Baker, Caitlynne Youmans, Cheng-Xian Yang, Hannah Carter, Jason Bolton*

Leveraging Homophily to Address Sustainable Development Goals: Implications for International Agricultural Extension's Maximum Impact | *Michael Moscarelli, Robert Strong, Gary Wingenbach, Theresa Murphrey*

Challenges and Use of Social Media in Agricultural Extension: Implications for International Extension Education | *Howard Wallace II, K. S. U. Jayaratne, Wendy Warner, J. Bloom, Julia McKeown*

Philosophical Shifts in Extension: The Urban Extension Initiative (UEI) Framework | *Kristina Hains, Bryan Hains, Reba Prather*

GROW WITH



From our agricultural roots into our artificial intelligence future, the Graduate School at the University of Florida has always been all about growth — personal, professional, national, global.



Explore our website to discover what growth lies in store for you in our 200-plus master's and 100 doctoral degree programs among 140 fields within the Gator Nation.

grad.ufl.edu



IDEAS AT WORK 4 | WEDNESDAY, APRIL 24 | 3:00 – 4:00 P.M.

Ideas at Work 4 | Theme: [Agricultural Innovation](#) | Coral Ballroom

Building Confidence Abroad: Impact of a Study Abroad Program on Student Confidence Levels when Communicating Internationally | Trevor Rawdon, Shannon Norris-Parish, Lacey Roberts-Hill

Designing for Success: Instructional Design to Support Online Teaching | Wendy Warner, Joy Morgan, Travis Park, Misty Lambert, Katlyn Foy

Developing Cultural Competence in Pre-service Agricultural Education Teachers | Joy Morgan, Andrew Waaswa, Becky Cibulskis

Softly Does It: The Art of Using Gentle Persuasion Techniques to Market Extension to Younger Audiences | Lauri Baker, Anissa Zagonel, Heather Young, Cheng-Xian Yang

Utilizing Farms of the Future Approach to Teach Farmers and Agricultural Leaders about Climate Change and Adaptation Strategies | Andrew Waaswa, Joy Morgan

Application of the Health Belief Model to Understand the Intentions of the Plain-Sect Populations to Adopt the Best Drinking Water Management Practices | Parmveer Singh, Anil Kumar Chaudhary

Formulating and Implementing Evaluation Framework for Localized Capacity Development Initiatives in Livestock Systems in Nepal and Rwanda | Laras Salsabila, Nargiza Ludgate, Erica Odera, Sarah McKune

ABSTRACT SESSION 7 | WEDNESDAY, APRIL 24 | 4:15 – 5:15 P.M.

Abstract Session 7-A | Theme: [Agricultural Systems](#) | Scarlet A

Exploring the Influential Factors Shaping Consumer Behavior and Purchase Intentions of Organic Seafood Products | Kamal Gosh, Yonathan Tilahun, Malcolm McCallum, Newton Nyairo

Satisfaction with Life and Intention to Migrate: An Analysis of Rural Youth in Honduran Agriculture | Debby Meléndez Castro, Luisa Correa Díaz, Sarahi Morales

First Research and Extension Efforts on *Listronotus Sparsus*, an Emerging Weevil Pest of Celery and Parsley in Florida | Anna Meszaros, Julien Beuzelin, Craig Frey

Environmental and Health Impacts of Specialty Crops in the US Midwest: A Qualitative Study Guided by the RE-AIM Framework | Whitney Fung Uy, Laura Balis, Katie Nelson, Maryan Isack, Emily Shaw, Laura Flournoy, Daniele Vest, Amy Yaroch

Abstract Session 7-B | Theme: [Awareness and Perceptions](#) | Scarlet B

How do Scientists Promoting Genetically Modified Seeds in Africa Build Trust? The Experience of Ghanaian Farmers. | *Joseph Gakpo, Katherine McKee*

Perceptions of Student Leadership Competency Development through Short-term Study Abroad Programs | *Hunter Carson, Newlin Humphrey, Bradley Coleman, Lauren Cline*

Farmers' Quality of Life, Self-leadership, and Ability to Teach Others | *Suzanna Windon, Daniel Robotham*

Abstract Session 7-C | Theme: [Extension Education](#) | Scarlet C

Adoption of Climate Smart Adaptation Practices in Priority Risk-prone Environments in Trinidad | *Wayne Ganpat, Jeet Ramjafan, Brandon Murphy*

Challenges Faced by Pakistani Farmers to Access Information about Adaptation Strategies to Climate Change: A Systematic Review | *Sana Ullah, Maria Navarro*

Strengthening Agricultural Extension Training: Process Skills and Competency Gaps in Undergraduate Agricultural Extension Curriculum in Malawi. | *Charity Chanza, Frank Tchuwa, Ifeoma Anugwa, Saweda Liverpool-Tasie, Dimelu Ukamaka, Agwu Agwu, Murari Suvedi, PVK Sasidhar*

Abstract Session 7-D | Theme: [Extension Education](#) | Scarlet D

Impact of Vocational Training on Income and Employment of Farm Women in India | *Laxmi Kandi, Kim Dooley, Prakhar Vaish*

The Relevance of Available Agricultural Advisory Higher Education Curricula: A South African Case Study | *Lindie von Maltitz, Kristin Davis, Murari Suvedi, P.V.K. Sasidhar, Johan van Niekerk, Charity Chanza, Maheshwari Elapata*

Transforming Youth into Agricultural Entrepreneurs: A Study of Songhai Center Graduates in Benin | *Michel Agodji, Stephen Mukembo, Laura McCann, Djana Mignouna, Augustin Aoudji, Razack Adéoti*



Join the Global Forum for Rural Advisory Services

Are you passionate about driving positive change in rural communities? Become a part of the Global Forum for Rural Advisory Services (GFRAS) community, the global voice that empowers farmers and rural communities via rural advisory services (RAS).

WHY JOIN GFRAS? WE PROVIDE



GLOBAL LEADERSHIP

GFRAS stands as the unparalleled global voice of RAS. As a member, you contribute to shaping the future of sustainable agriculture worldwide.



PROFESSIONALIZATION

We are committed to advancing the professionalization of RAS. Join us in elevating the standards and impact of RAS professionals globally.



FREE RESOURCES

Gain access to a treasure trove of free-for-use materials, training modules, and resources tailored for RAS professionals. Enhance your knowledge and skills to make a lasting impact on rural development.



SHARED LEARNING

Join our vibrant community of like-minded individuals and organizations. GFRAS is your platform for shared learning, collaboration, and networking. Learn from global experiences and share your insights to foster collective growth.

HOW TO JOIN

Visit our website at www.g-fras.org and subscribe to the GFRAS Updates. It is free of charge and that simple! Your commitment to rural development starts with a simple click!

👉 Together for Rural Advisory Services.

Ideas at Work 5 | Theme: Agricultural Communications, Education, and Leadership | Coral Ballroom

Evaluating Vaccine Use in Farmed White-tailed Deer in Florida: Identifying Knowledge Gaps and Strategies to Increase Deer Health | *Samantha Wisely, Juan Campos Krauer, Ashley Petersen, Yasmin Tavares*

A Systems Thinking Approach to Eliminating Rural-Urban Youth Out-Migration and its Effect on the Agricultural Sector in Nigeria | *Israel Oyedare, Eric Kaufman, Emmanuel Ojo, Jessica Spence*

Addressing Major Challenges in Florida's Emerging Rice Industry | *Mathew VanWeelden, Jehangir Bhadha, Julien Beuzelin, Calvin Odero, Daniel Cavazos*

The Power of Online Seminars to Guide Development of Online Modules: A Case Study | *Theresa Murphrey, Sophia Wegeng, Megan Greenwood, Danefe Philpott, Carmen Benson, Lisa DeLeon*

Opportunities and Challenges for Land-Grant Institutions to Engage with International Volunteer Programs | *David Ader, Brian Flanagan, Hans Goertz, Tom Gill, Michelle Boutell*

The Role of Experiential Learning in Helping Agricultural Graduates Develop Core Skills Needed to Excel at the Workplace: A Case Study of [Organization's] Work in Africa | *Chiamaka Ndukwu, Sarah Bush, Natalie Coers*

Global Leadership Student Opinions of Sustainable Development Goals: A Double Q-sort Case Study | *Natalie Coers*

POSTER PRESENTATIONS | MONDAY, APRIL 22 | 4:45 – 6:15 P.M.

- 1. A Needs Assessment of Georgia Elementary Agriculture Education Teachers** | *Eric Rubenstein, Anna Schyette, J. Martin, Taylor Bird, Ian Marburger*
- 2. A Qualitative Content Analysis of News Coverage about Meat and Livestock Australia's Carbon Neutral 2030 Initiative** | *D'arcy Ryder, Courtney Meyers*
- 3. A Survey of International Graduate Students' Food Insecurity Experiences at a Land-Grant University** | *Alice Akers, Caroline Nickerson, Caitlin Lunzmann, Madison Dymont, Jamie Loizzo*
- 4. Adoption of Hybrid Rice in Selected Areas of Bangladesh** | *Md. Fazlul Hoque, Mohammad Amir Hamza Miah, Mohammad Anamul Haque*
- 5. Are the Extension Workforce Ready? Navigating the Extension Professionals in "Developing World" through Highlighting the Key Competency Areas** | *Samrat Sikdar, Nesma Osman*
- 6. Assessing the Perceptions of Urban Young Adults toward Urban Agriculture Careers in Florida** | *Sravani Pasula, Laura Warner, Catherine Campbell, Sreedaya GS*
- 7. Awareness and Usage of Hermetic Storage Bags by Smallholder Farmers in Dormaa, Ghana** | *Namah Taku-Forchu, Misty Lambert, Michael Retallick, Jonathan Ulmer, George Opit*
- 8. Burnout Syndrome: Exploring Gender Dynamics in the Agricultural Industry of Latin America** | *Sarahi Morales, Daniela Perez Vivanco*
- 9. Case Study: Catracha Coffee, a Replicable Business Model?** | *Suleima Patt, Sarahi Morales, Julio Rendón*
- 10. Citizen Diplomats for 4-H: Partnerships to Provide a Globally Focused Extension Program** | *Nick Simmons, Brian Estevez, Aly Schortinghouse, Jereme Johnson, Haylee Linam*
- 11. Climate Change Readiness Among Farmers and Extension Providers in Trinidad and Tobago** | *Jeet Ramjattan, Wayne Ganpat, Brandon Murphy*
- 12. Communicating with Impact Using Art or Science: Examining Student Reactions to Media Portrayals of Animal Agriculture** | *Fallys Masambuka-Kanchewa, Alexa Lamm, Shuyang Qu, Michael Retallick, Catherine Sanders, Kevan Lamm*
- 13. Connecting Big Data to Sustainable Development in an Interdisciplinary University General Education Course** | *Sarah Bush, Carrie Baker*
- 14. Consumer Awareness of and Willingness to Pay for Traceable Honey in Central Uganda** | *Charles Kironde, Samuel Ikendi, Steven Lwasa, Rosemary Isoto, Rose Somers*
- 15. Critical Issues Facing Controlled Environment Agriculture in the Horticulture Industry: Implications for Global Audiences** | *Andrews Idun, Kevan Lamm*

16. **Current State and Future Potential of Using Climate Decision Support Tools for Agricultural Decision-Making in California** | *Samuel Ikendi, Vikram Koundinya, Namah Taku-Forchu, Natalia Pinzon, Lauren Parker, Leslie Roche, Mark Cooper, Daniele Zaccaria, Steven Ostoja, Tapan Pathak*
17. **Design, Construction, Fabrication, and Testing of an Indirect Heated Biomass Grain Dryer Appropriate for Low-Income Communities** | *Esther Asimo, Julia Kigozi, Robert Kambugu, Thomas Brumm, Samuel Ikendi, Rose Somers*
18. **Determining the Employment Needs and Agricultural Literacy Content of Agriculture, Food, and Natural Resource Industry Professionals in [State]** | *Cassandra Goff, Jason Dossett, Suzanna Browning, R.G. Tre Easterly III*
19. **Drought is Universal, but Not Indistinguishable: Investigating How Traveling Abroad Challenges Perspectives** | *Madeleine Gardner, Lacey Roberts-Hill, Shannon Norris-Parish*
20. **Environmental Value of Christian Agricultural Development Workers** | *Susan Reams, Natalie Coers, Sadie Hundemer*
21. **Evaluating a Virtual Interdisciplinary Team for Gender Capacity Building: Recommendations and Guidance for Agriculture and Development Professionals** | *Alexis Zickafoose, Theresa Pesl Murphrey, Rafael Landaverde, Manuel Pina Jr., Melina Gracia*
22. **Explain the Relationship between Extension Volunteer Leadership Competencies and Their Age, Education Level, and Employment Status** | *Suzanna Windon, Olga Buchko*
23. **Exploring Cultural Competency & Personal Growth in a Short-Term Study Abroad Program** | *Lauren Chase, Whitney Stone, Dawn Moyer, Melissa Millhollin*
24. **Factors Affecting Adoption of Improved Vegetable Farming Technology on Kaski District Nepal** | *Upakar Bhandari, Jeremy Engel*
25. **From Gender-blind to Gender-transformative: Evolution of Extension Approaches** | *Arati Joshi, Kathleen Colverson, Fallon Y Riaño-Jiménez, Steven Franzel*
26. **From Seeds to Success: The Role of 4-H Ghana in Fostering Agricultural Careers** | *Jessica Spence, Meikah Dado, Sherrie Ray, Jack Elliot*
27. **Harnessing the Use of Nature-based Solutions for Landslide Risk Mitigation in the Mount Elgon Region of Uganda** | *Lilian Kempango, Shafiq Nedala, Samuel Ikendi, Udo Nehren, Bob Nakileza*
28. **Impact of Global Service-Learning on Alumni Improvements in Professional Skills** | *Samuel Ikendi, Michael Retallick, Gail Nonnecke, Grace Lubaale, Gregory Miller, Donald Kugonza, Francis Owusu, Thressa Cooper*
29. **Improving Household Dietary Diversity and Caloric Intake Through Livelihood Education Interventions in Eastern Uganda** | *Samuel Ikendi, Francis Owusu, Dorothy Masinde, Ann Oberhauser, Carmen Bain*
30. **In a Position of Passionate Purpose: A Case Study Exploring the Work Passion of U.S. Extension Employees Within the State of Maine** | *Lauri Baker, Anissa Zagonel, Ashley McLeod-Morin, Sandra Anderson, Jason Bolton, Hannah Carter*

NC STATE
UNIVERSITY

College of Agriculture
and Life Sciences



Learn about the Department of Agricultural and Human Sciences

Featuring:

- New & Events
- Faculty Features
- Alumni Spotlight
- Awards & Recognition
- Student Stories

Learn More:



Academic programs offered:

- Bachelor's in Agricultural Education
- Bachelor's in Agricultural Science (in-person or online)
- Master's in Agricultural and Human Sciences (with four concentration areas)
- Doctoral in Agricultural and Extension Education

go.ncsu.edu/AHS-dept

 @AHSNCState  @AHSNCState  @AHSNCState  /AHSNCState

31. **Influence of Information Sources and Social Media Plagorms on Digital Agricultural Technology Adoption** | *Hema Lingireddy, Hansram Meena, Rama Radhakrishna*
32. **"It's Not for Me!": A Descriptive Review of Barriers and Stigmas Surrounding Food Pantries** | *Fisher Easley-Smith, Lacey Roberts-Hill*
33. **Leadership for the Ages: Cultural Intelligence Development in a Greek Study Abroad Experience** | *Sarah Bush, Megan Cantrell, Natalie Coers*
34. **Mapping Flood Susceptibility Hotspots and Assessing Mitigation Measures in the Mount Rwenzori Region of Uganda** | *Shafiq Nedala, Sengupta Puja, Lilian Kempango, Samuel Ikendi*
35. **Moodle platform adoption by class of 2021 for e-Learning at Botswana University of Agriculture And Natural Resources** | *Keba Hulela, Fally Masambuka-Kachewa, Dorcus OokeditseKachikao Junior secondary*
36. **On-farm Demonstrations of Anaerobic Soil Disinfestation for Organic Production** | *Yvette Goodiel, Kate Rotindo, Nan Xu, Isaac Vincent, Xin Zhao, Jason Hong, Francesco Di Gioia, Erin Roskopf*
37. **Plugging into the New Farming Era of "Information and Communication Technologies" (ICTs): Empirical Evidence on Farmers' e-readiness from Karnataka State of India** | *Manjuprakash, Samrat Sikdar, Rahul Bellagi*
38. **Powerful and Personally Paced: Perfecting Interactive Data Visualization for Adult Learners with Power BI** | *Caitlynne Youmans, Lauri Baker, Matt Benge*
39. **Professional Communication Skills for the Future Career Success: A Perceived Training Needs Analysis of the students in an Indian Agricultural University** | *Samrat Sikdar, Satya Prakash, Ashok Singh*
40. **Program Assessment of Count on Me NC: a Behavior and Science-based COVID-19 Risk Management Training Program in North Carolina** | *Gabriela Arteaga-Arredondo, Ellen Shumaker, Benjamin Chapman*
41. **Reframing Community-Based Reintegration Approach for Building Resilience of Returning Migrants and Vulnerable in Kano State, Nigeria** | *A. Abdullahi, M. Hussaini, A. Mustapha, S. Inusa, A. Nasir, J. Bichi, A. Mustapha, H. Yusuf, M. Halliru, A. Shuaibu, Z. Dankoli, I. Muhammad, A. Zubairu*
42. **Rooftop Gardening Risks in Urban Agriculture: Assessing the Residents' Perspectives** | *Md. Mithun, Saifur Rahman, Joseph Donaldson*
43. **Rooted in Well-Being: An Exploration of Community Gardens and Their Impact on Mental Health** | *Elisabeth Ramsey, Monipel Babb, Catherine Sanders, Katherine McKee*
44. **Rural Colombian Students' Motivation to Participant in an International Internship** | *Carlos Parra, Neil Knobloch*
45. **Students' Sentiments And Perception Of Roundtable Classrooms and Adapted Pomodoro Technique in Agricultural Classes** | *Sofia Brizuela-Obando, Nour Rabieh, Austin Moore, Esteban Montenegro-Montenegro*
46. **Technology Use and Impacts on Agricultural Extension: A Scoping Review** | *Anjorin Adeyemi, Shuai Ma, Zhihong Xu, Emily Catalan, Ashlynn Kogut, Cristina Guzman*

47. **The Effect of COVID-19 Pandemic on the Use of Social Media in Extension Work: Implications for Extension Communication** | *Howard Wallace II, K. S. U. Jayaratne, Wendy Warner, Dara Bloom, Julia McKeown*

48. **The Influence of Calling and U.S. and Internationally Based Adult Educator Work Experiences on Career Commitment** | *Steven Siegelin, Marina Denny, Julie Robinson*

49. **Time-Series Analysis of Livestock Mobility in Ghana** | *Christiana Terkper, Daniel Nyarko, Fallys Masambuka-Kanchewa*

50. **Unveiling Perspectives: A Cross-Border Exploration of Teaching Practice Assessment among Agricultural Student Teachers in Kenya and the United States of America** | *Gilbert Odilla, Rachel Mittman, David Lawver*

51. **Using Photo Journal Prompts to Help Increase Local Cultural Awareness in Study Abroad Participants** | *Bryce Hamlin, David Lawver, Courtney Gibson, Clarissa Darby*

52. **What are the Perceived Weather-Related Adaptation Needs of Agricultural Operations in the Southeast U.S.?** | *Andrew Waaswa, Joy Morgan, Michael Gavazzi, Steven McNulty*

53. **When Your Work is Your Life: Young Adults in Production Agriculture Story of Hard Work** | *Meikah Dado, Jack Elliot*

CFAES



Applications are due
DECEMBER 1.

DEPARTMENT of
AGRICULTURAL COMMUNICATION, EDUCATION, and LEADERSHIP

GRADUATE PROGRAMS

The ACEL graduate program offers three Master's Degrees: Master of Education (M.Ed.) for those interested in earning certification to teach in a K-12 environment, an online Master of Science (M.S.) and an in-person Master of Science (M.S.).

Additionally, ACEL offers a Doctor of Philosophy in Agricultural Communication, Education, and Leadership. Graduate students in ACEL can specialize in agricultural communication, agricultural education, community and extension education and leadership.



THE OHIO STATE UNIVERSITY
COLLEGE OF FOOD, AGRICULTURAL,
AND ENVIRONMENTAL SCIENCES

Questions?

Derek Peterson
Graduate Program Manager
FAES-acelgradprogram@osu.edu

Dr. Joy Rumble
Director of Graduate Studies
rumble.6@osu.edu

GEORGIA



Department of Agricultural Leadership, Education and Communication

College of Agricultural & Environmental Sciences

UNIVERSITY OF GEORGIA

The University of Georgia's Department of Agricultural Leadership, Education, and Communication (ALEC) emphasizes messaging, education, and leadership for the advancement of agricultural and environmental science. Contributing to Georgia's land grant mission, ALEC offers diverse opportunities for research, coursework, and more.

www.alec.caes.uga.edu

1785



Tours

Urban Agriculture

The Orlando area offers a unique and refreshing opportunity to see agricultural production at its best. You will see a small scale, organic farm, producing high quality produce for the local community in an environmentally sustainable fashion.

Next stop will be a traditional farm located on the fringe of urban sprawl that also engages in many agritourism events and we will enjoy lunch in their café. They also have a country store with locally produced items.

Next, we will visit a hydroponics production located inside the Orange County Convention Center. The produce is sold and used by the chef at the convention center. It doesn't get any fresher than that!

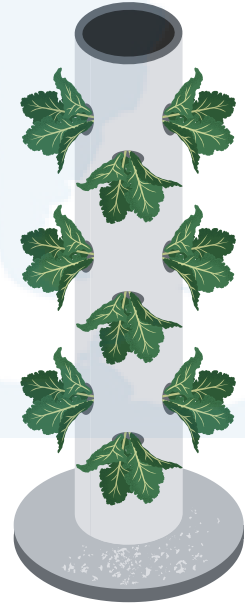

Florida Agriculture and Community Food Systems

Florida boasts a wide variety of agricultural products that span much further than the well-known citrus industry. This tour will provide a glimpse into this diversity of crops and products while also providing insight into nonformal community-based agricultural education.

A few highlights will include a community engagement effort in local food systems, a neighborhood market with some of Central Florida's top food entrepreneurs, and floriculture.

This tour will be marked by highlighting the diversity and economic value of Florida's agriculture and community food systems.





*Thank you for
conferencing with us!*

OUR CORPORATE SPONSORS:



Peace Corps



**Department of Agricultural Leadership,
Education and Communication**

College of Agricultural & Environmental Sciences

UNIVERSITY OF GEORGIA